



**ENGINEERING
&
GEOSPATIAL SERVICES**

STATEMENTS OF INTEREST & QUALIFICATIONS Professional Engineering Services

September 1, 2021

Farmdale Creek Trunk Sewer Analysis Washington, IL



CELEBRATING **75** YEARS OF
EXCEPTIONAL SERVICE. NOTHING LESS.
twm-inc.com

	Pages
Introduction	
• Cover Letter	2
A) Qualifications of Firm	
• Success of Previous Projects	3
• Project Understanding & Approach	4
B) Project Management & Key Personnel	
• Recent Project Experience	5-6
• Ability to Meet Schedule & Budget	7
• Professional Qualifications	8
C) Staffing & Workload	
• Staff Capabilities	9
• Resumes	10-13
• Workload Capacity & Availability	14
Conflict of Interest / Disclosure Statement	15



“ We bring **75 years** of **experience** and knowledge to projects and **solving problems**. We build **strong relationships** with our clients so you can expect a **trusted partner** who values **quality, stability,** and **loyalty.** ”



CONSULTING ENGINEERING
GEOSPATIAL SERVICES

THOUVENOT, WADE & MOERCHEN, INC.

ST. LOUIS BRANCH OFFICE
720 OLIVE STREET, SUITE 200A
ST. LOUIS, MO 63101
314.241.6300
TWM-INC.COM

September 1, 2021

City of Washington, IL
Attn: Dennis Carr, City Engineer
301 Walnut Street
Washington, IL 61571

RE: Request for Statements of Interest & Qualifications | Professional Engineering Services for the Completion of a 3rd Party Alternative for Farmdale Creek Trunk Sewer

Dear Mr. Carr and Members of the Selection Committee:

We enthusiastically submit our interest to provide professional engineering services for the Farmdale Creek Trunk Sewer analysis. TWM offers a proven team who understands your project, will represent your interests, and advise you of the solutions that best meet your particular needs. You want a firm with experience, knowledge, and skill who will listen, communicate effectively, pay attention to detail, and ultimately deliver a quality product. TWM's mission encompasses all those things and is what we pledge to each of our clients: ***Exceptional Service. Nothing Less.***

Your review project is especially suited to our professional expertise, having worked on countless projects within Illinois and Missouri over the last 75 years. At TWM, our passion for delivering excellent projects is only matched by our willingness to go above and beyond to satisfy client needs—everything from meeting or exceeding tight schedules, innovating cost-effective solutions, and staying engaged throughout the entire project. We wish to continue developing our relationship with the City of Washington and demonstrate that we never take our clients for granted.

As you will see in this statement of interest and qualifications, our team has extensive, practical experience in public sector engineering, including sanitary sewer and water distribution system design. We hope you're excited to select TWM as a trusted firm to deliver exceptional engineering services and we pledge to show you first-hand why choosing the TWM team is the right decision.

After reviewing our qualifications, we're confident you'll find that TWM is the right choice to deliver water infrastructure improvements to your community. We look forward to the possibility of working with you. If you need additional information or have questions, please contact me at **314.241.6300** or **cbergmann@twm-inc.com**.

Sincerely,

TWM, Inc.

Christopher Bergmann, PE, LEED AP BD+C | Project Manager
St. Louis Branch Office
720 Olive Street, Suite 200A
St. Louis, MO 63101

Qualifications of Firm

“

We're passionate about solving the most difficult infrastructure challenges our clients face by providing

Effective, Efficient, and Economical Solutions

”

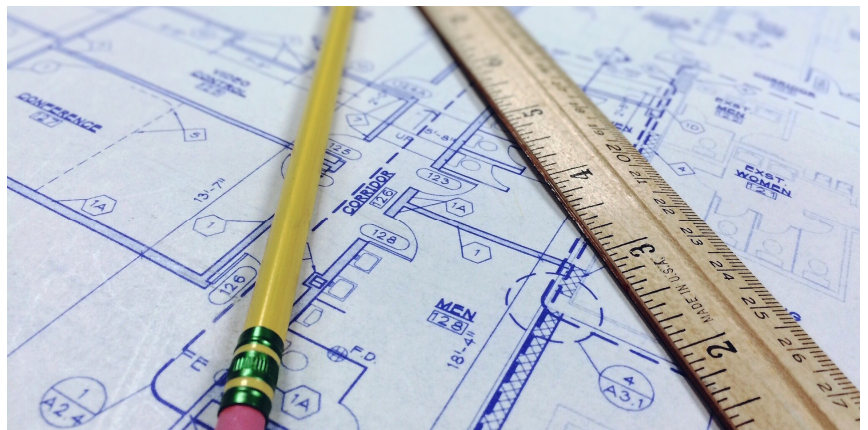



we understand the specific scope of work for your project

At TWM, our engineers have experience designing wastewater interceptors, collection systems, lift stations, the separation of combined sanitary and storm sewer systems to reduce CSOs, wastewater treatment systems, and in securing and managing grant and loan funding for our clients.

Our typical services include:

- Wastewater treatment facilities
- Transmission, collection, and conveyance
- Enhanced nutrient removal upgrades
- Sludge treatment and disposal
- Disinfection of water and wastewater
- Booster and pump stations
- Lift stations
- Force mains
- Compliance assistance
- Facility planning
- SCADA and electrical systems
- Inflow and infiltration analysis/correction
- Combined sewer overflow (CSO) long-term control plans
- User charge rate studies

we take pride in our quality of service

Being 100% accountable for the deliverables that we provide over the course of our partnership with clients is reflected in our company's defining mission: **EXCEPTIONAL SERVICE. NOTHING LESS.** In order to fulfill our mission, quality must be and is a top priority in our daily efforts. TWM employs specific operating procedures to provide our clients with superior products and services. One of those processes involves perceiving projects not only from an efficient and effective design, but also one that is economically palatable.

TWM's QA/QC Policy | The success of a project has a direct correlation to the quality of service and deliverables provided by the chosen consultant. In every project we undertake, we use sound quality assurance and control practices. Our QA/QC Policy:

- Establishes basic fundamental parameters for the development of a project-specific QA/QC Plan, which in turn defines the components of necessary QA/QC measures to develop quality project deliverables.
- Defines the responsibilities of each staff member involved in this process, the project phases and frequency of practicing QA/QC activities, the methods of documenting QA/QC events/reviews, and individual accountability, all in an effort to:
 - 1) prevent errors from being introduced into the engineering, design, plans, and cost estimates,
 - 2) ensure errors are detected and corrected as early as possible, and
 - 3) identify and eliminate the cause of errors.

While primary responsibility for the project's QA/QC will be managed by Vicki Wade, PE, at TWM, we abide by the fundamental understanding that good quality is the result of several processes, not just a single process. It requires many individuals performing many appropriate activities at the right time during the project deliverable development process. Providing a quality product is not solely accomplished by means of a review after the product is completed. It is an approach and a realization that quality is something that occurs throughout the design process. Quality requires performing all activities in conformance with valid requirements, no matter how large or small their overall contribution to the design process.



one of our many client success stories

"During the past 10 years, TWM has produced Facility Plans for expansion of our treatment facility, significant extensions of our potable water distribution system, and construction of our new water tower. All of these projects were well planned, designed, and constructed within budget, and completed in an expedient manner. TWM works in both a respectful and helpful manner with all our municipal departments. TWM understands our budget constraints and performs due diligence to make sure the infrastructure solutions they recommend are wise investments for our community. They truly keep our best interests in mind."

—Michael H. Todd
Mayor & Village President
Village of Millstadt
618.476.1514

general work plan

Upon reviewing both presentations as well as the original engineering report, it's clear that the challenges related to conveying wastewater from the soon to be decommissioned treatment plant are complex and that emotions have run high. While a large amount of information has been provided, there is likely substantial information that the City is familiar with that cannot be captured in the documentation. As such, the first step in the process will be to meet with the City to discuss anything and everything that we should be aware of that is not fully captured in the presentations.

As the 3rd party reviewer, we understand that both sides want a fair and reasonable decision. In order to obtain this outcome, we will pay close attention to the assumptions made by each of the previous engineering firms and weigh the effect that these assumptions will make on design.



As we move forward with our analysis of the various alignments and our recommendation, **two overarching factors will be considered—cost and external factors.**

- We'll look at unit costs as well as evaluate potential costs that were not considered previously, but that we believe to be important to the analysis decision.
- The primary external factor of importance in this specific project is the perception of the public and the potential resulting costs. Many times, the public, and directly affected landowners, do not view the needs/benefits of a project in the same eyes as the City. These misunderstandings will lead to apprehension on both sides. It seems that this may be the case in this situation but discussions with the City will help us to better comprehend the full extent.

Included with the public perception of this project is the fact that the area between STP-1 and STP-2 is inundated with wetlands, floodplains, historical sites, and endangered species. It's an age-old problem comparing the benefits of development vs. the need to protect the environment in which we live. Today, more and more options have become available so that the two do not have to be in stark contrast with each other. We will review the existing outreach that has already occurred and will conduct additional research as necessary while keeping in mind that any mitigation needed for these factors must be reflected in the costs.

Once our analysis is complete, we will provide a recommendation that may not be the lowest cost but that will take all factors into consideration. Considering that many of the above factors have high-cost variability, as appropriate, we will develop a range of costs for "best" and "worst case" scenarios for each alignment. Knowing that the landowners generally agree with the purpose of this project but also understand that one of the goals of the new trunk sewer is to "be responsible to the taxpayer by implementing a cost-effective solution", this range of costs will be a driving factor for our recommendation.

utility pipeline design experience

	Route Options	Environmental Impacts	Construction Issues
CSO Phase 4 Belleville, IL	x	x	x
CSO Phase 3 Belleville, IL	x	x	x
CSO Phase 2 Belleville, IL	x	x	x
Belle-Valley Interceptors	x	x	x
Weinel Hills	x	x	x
MGP Remediation Site—Sewer Relocation	x	x	x
Capitol Oaks South Sanitary Sewer Improvements	x		x
Capitol Oaks Sewer Improvements	x		x
Laurel Drive & Susan Court Sanitary Sewer Replacement	x		x
Crossroad Terrace Sanitary Sewer Replacement	x		x
Lee Avenue Storm Sewer Improvements	x		x
Fort Leonard Wood AC Water Main Replacement	x	x	x
Park Street Life Station and Force Main	x	x	x
Rieder Road Lift Station and Force Main	x	x	x
Route 3 Water Main Improvements	x	x	x

Project Management & Key Personnel

“

Our firm is an ideal size large enough to take on major projects
but small enough to respond to needs quickly.

We Have the Resources for Nearly any Type of Project

”



PROJECT MANAGEMENT & KEY PERSONNEL | Recent Project Experience



USMH: West D St In Sidewalk
DSMH: 331 N. 9th St.



Access Point Manhole
entire floor missing

West "E" Street Combined Sewer Replacement

Owner | City of Belleville, IL

Reference | Randy Smith,
Director of Wastewater
Treatment Plants and Sewer
618.233.7146

Cost | \$850,646

Timeline | 2016

Team | Vicki Wade, PE; Scott
Simmons, PE

description & scope of work

The existing 12" combined sewer was undersized. To resolve the issue, TWM prepared plans to replace the existing sewer with a 24" combined sewer and also install new dedicated storm sewer lines to provide some separation at intersections along the alignment. The improvements were based on findings in the City's video inspection and modeling that TWM completed of the City's combined sewer system as part of the CSO Long-Term Control Plan.

Relevance to the City of Washington

- Interceptor sewer design



CSO LTCP Phases 3 & 4 | 23rd Street CSO Lift Station

Owner | City of Belleville, IL

Reference | Randy Smith,
Director of Wastewater
Treatment Plants and Sewer
618.233.7146

Cost | \$21,551,361 (Phase 3);
\$7,394,377 (Phase 4)

Timeline | 2017 (Phase 3);
2019 (Phase 4)

Team | Vicki Wade, PE

description & scope of work

Phase 3: TWM prepared plans for a pump station with a flow rate of 90 MGD. Design included interceptors as large as 84" in diameter, four pumps, wet well and valve vault that were part of the pump station, screening, and two parallel 48" force mains approx. 6,500' in length. Phase 4: TWM prepared plans for a CSO pump station with a flow rate of 25 MGD. The design provided influent screening and included gravity sewers to transport flow to the pump station.

Relevance to the City of Washington

- Large scale sewer design
- Crossings of railroad and State highways

PROJECT MANAGEMENT & KEY PERSONNEL | Recent Project Experience



MGP Remediation Site—Sewer Relocation

Owner | PSC Industrial
Outsourcing, Inc.

Reference | Charlie Klumb
618.281.1412

Cost | \$800,000 (est)

Timeline | 2017

Team | Scott Simmons, PE

description & scope of work

This project relocated 850' of 36" - 42" combined sewer interceptors as part of a larger project to remediate the soil from an old power plant site and along a major creek. The existing sewer was in a congested area, requiring the design to account for multiple roadway crossings, creek proximity, and several utilities. TWM used CCTV in an existing 36" brick combined sewer to determine where and how to divert flow from the relocated sewer.

Relevance to the City of Washington

- Large scale sewer design
- Sewer design in proximity to creek



Weinel Hills Sanitary Sewer System

Owner | Caseyville Township,
IL

Reference | Randy LePere,
Interim Sewer Manager
618.632.2414

Cost | \$6,129,374

Timeline | 2015

Team | Chad Ross, PE; CPESC;
Chris Bergmann, PE

description & scope of work

Due to the difficulty of installing a sewer on this hilly terrain surrounding a lake, homes in this subdivision used privately-owned aeration and septic systems. The water quality of the lake was impacted by seepage from these systems, so TWM designed a replacement sewer system. Design included a combination of gravity sewers, low pressure sewers, grinder pumps, and 7 lift stations. Project needed 3 separate crossings of State highways, requiring coordination with IDOT.

Relevance to the City of Washington

- Multiple road crossings with pipelines
- Coordination with several property owners

PROJECT MANAGEMENT & KEY PERSONNEL | Recent Project Experience



Laurel Drive & Susan Court Sanitary Sewer Replacement

Owner | Caseyville Township, IL

Reference | Randy LePere, Sewer System Manager
618.632.2414

Cost | \$594,000 (est)
\$582,565 (act)

Timeline | 2020 (design)

Team | Scott Simmons, PE

description & scope of work

Sewers in this area were prone to surcharging during rain events due to age and condition of the pipes and manholes. TWM provided surveying, design, and bidding services to replace nearly 2,600 LF of gravity mains and 10 manholes. The existing sewer was located in the middle of residential streets requiring coordination with homeowners as well as City street department to minimize impacts during construction.

Relevance to the City of Washington

- Construction staging plans
- Coordination with residents and City departments



Capitol Oaks South Sanitary Sewer Improvements

Owner | Caseyville Township, IL

Reference | Randy LePere, Sewer System Manager
618.632.2414

Cost | \$328,000 (est)
\$313,046 (act)

Timeline | 2020 (design)

Team | Scott Simmons, PE

description & scope of work

Replacement of approx. 2,950 LF of gravity sewers as part of ongoing efforts to replace deteriorated infrastructure in older portions of the system. The existing sewer was located within back yard easements requiring coordination with homeowners. The project also included a creek crossing. A portion of the project was funded through a Community Development Brock Grant which TWM assisted the Township in obtaining.

Relevance to the City of Washington

- Construction through yards
- Installing sewer beneath existing obstruction

PROJECT MANAGEMENT & KEY PERSONNEL | Recent Project Experience

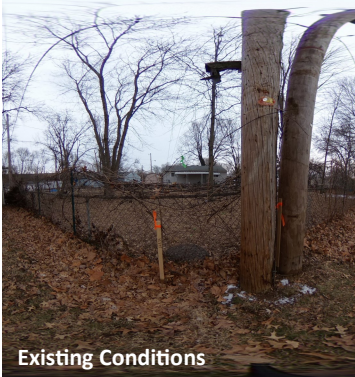

Existing Conditions

Crossroad Terrace Sanitary Sewer Replacement

Owner | Caseyville Township, IL

Reference | Randy LePere, Sewer System Manager
618.632.2414

Cost | \$349,000 (est);
\$326,300 (act)

Timeline | 2018 (grant); 2019 (design/constr)

Team | Scott Simmons, PE

description & scope of work

Project replaced deteriorated VCP gravity sewer and brick manholes that had high I/I with new PVC mains and precast concrete manholes. Scope involved replacement of 2,600 LF of sewer main and 20 manholes. Numerous existing lamp holes were replaced with new precast manholes to aide in system maintenance. A portion of the project was funded through a Community Development Brock Grant, which TWM assisted the Township in obtaining.

Relevance to the City of Washington

- Evaluating/replacing sewers with I/I problems
- Construction near high traffic roadway



Capitol Oaks Sewer Improvements

Owner | Caseyville Township, IL

Reference | Randy LePere, Sewer System Manager
618.632.2414

Cost | \$214,000 (est);
\$232,706 (act)

Timeline | 2018

Team | Scott Simmons, PE

description & scope of work

This project replaced nearly 2,000LF of 8" gravity sewer mains. Portions of the existing sewer were located within back yard easements requiring coordination with homeowners as well as significant coordination with other utilities impacted by construction. A portion of the project was funded through a Community Development Brock Grant which TWM assisted the Township in obtaining.

Relevance to the City of Washington

- Construction through yards
- Coordination with utilities and residents

ability to meet schedule/budget

To keep the project on schedule and within budget for the scope of services, TWM will:

- Define a precise scope of work to deliver the most cost-effective design and survey proposal for the City.
- Meet design budgets and provide accurate opinions of cost.
- Develop a project schedule in conjunction with the City that is reasonable and considers critical path issues.
- Monthly update to the City on the defined schedule as well as how the design project budget will be expended.

Project Name Client	Estimated vs. Actual Design Schedule	Estimated vs. Actual Construction Costs
2nd & Lawrence Storm Sewer St. Charles, MO	7/2018 7/2018	\$2,058,056 Undisclosed
Boyer Storm Water Improvements O'Fallon, MO	3/2018 3/2018	\$87,732 \$79,990
Dorchester Storm Water Improvements O'Fallon, MO	3/2018 3/2018	\$83,638 \$95,138
West Plant Water System Improvements Caseyville Township, IL	10/2017 10/2017	N/A \$50,451
Lee Avenue Storm Sewer Improvements St. Louis MSD	8/2016 8/2016	\$461,000 \$395,450
Supply Side Transmission Main and Water Distribution Main Troy, IL	1/2017 1/2017	\$388,628 \$229,366
MGP Remediation Site—Sewer Relocation PSD Industrial Outsourcing	4/2016 4/2016	\$850,000 \$750,882
Pralle Lane Water Upgrades St. Charles, MO	12/2015 12/2015	\$492,900 \$478,852
10th Street Water Main Replacement Mascoutah, IL	6/2015 6/2015	\$33,977 \$37,480
Wastewater Treatment Plant Upgrades & Extension Fayetteville, IL	12/2014 12/2014	\$1,493,000 \$1,692,987
10th Street Water Main Extension Mascoutah, IL	11/2014 11/2014	\$142,094 \$132,157

“ We understand the impact of project challenges and will find solutions to complete your project correctly. We have a dynamic team of talented individuals who are eager to tackle your project. As your trusted partner, **Our Work will be On Time, In Budget, and Done Right** ”





we have the water infrastructure experience to meet your needs

TWM, Inc. is a 100% employee-owned firm providing civil and structural engineering, land surveying, and other geospatial services. For 75 years, we have served both the public and private sector throughout the Midwest, and beyond.

TWM has a full-service Water Infrastructure Group. Our firm has provided facility planning and design services for a wide range of projects—meeting or exceeding EPA standards, NPDES permit limitations, and client demands for innovation. We have expertise in the design of interceptors, collection systems, sanitary sewer modifications (force mains, gravity flow, lift stations), the separation of combined sanitary and storm sewer systems (CSOs), water towers and water distribution systems, and in securing and managing grant and loan funding for our clients. Many of the treatment plants designed by TWM have been nominated as an “EPA Plant of the Year.”

We always design with sustainability and environmental factors in mind, but especially so when it comes to water infrastructure. Our process is typically iterative; meaning we complete drawings and specifications in phases, providing ample opportunity for feedback before final plans are delivered. As needed, we can provide extensive reality capture services, including conventional surveying, mobile LiDAR, and UAVs. Our staff have extensive experience in permitting, grant writing, bid phase services, and construction observation. In cases where geotechnical or electrical expertise is required, we have strong relationships with local, DBE firms to subcontract.

FIRM CAPABILITIES | TWM has the resources of a larger firm and the personalized customer service of a small, family-oriented firm working for local communities. With **129 licensed professionals and support staff**, our firm is an ideal size—large enough to take on major projects but small enough to quickly respond.

Because each employee brings a unique skill set to every project, we thoughtfully form project teams to best meet the particular needs of each assignment. Depending upon the scope and tasks of the particular project, our broad range of capabilities can meet a variety of civil and structural engineering needs for nearly any type of project. **Your project will be led by Chris Bergmann, PE, LEED AP BD+C, from our St. Louis office** (*contact info below).

We continually strive for the most efficient, effective, and economical solutions to address our clients' problems with the highest level of technical expertise, and without compromising quality or integrity. We pledge to serve as your trusted partner to help you resolve the engineering challenges you face.

EXCEPTIONAL SERVICE. NOTHING LESS. | That’s our company mission and our promise to you. Our success is built upon a solid reputation for getting the job done right. We’re particularly proud that approximately **95% of TWM’s work comes from repeat business**. Our resolution of challenges is what sets us apart, and based on our level of repeat business, we think our clients agree.



8 Office Locations in 3 States Project Office Location*	
ILLINOIS	MISSOURI
Swansea (HQ)	St. Louis*
4940 Old Collinsville Road	720 Olive Street, Suite 200A
Swansea, IL 62226	St. Louis, MO 63101
618.624.4488	314.241.6300
Edwardsville	St. Charles
600 Country Club View,	400 N. Fifth Street, Suite 101
Suite 1	St. Charles, MO 63301
Edwardsville, IL 62025	636.724.8300
618.656.4040	Columbia
Waterloo	3316 Lemone Industrial Blvd.,
113 South Main Street	Suite 2
Waterloo, IL 62298	Columbia, MO 65201
618.939.5050	573.442.6474
Peoria	TENNESSEE
1014 W. Pioneer Parkway	Franklin
Peoria, IL 61615	504 Autumn Springs Court,
309.326.6030	Suite B-14
	Franklin, TN 37067
	615.814.7414

TWM by the numbers

9th Largest Engineering Firm in the St. Louis Region
St. Louis Business Journal

38 Licensed Professional Engineers, including:
7 Licensed Structural Engineers
&
2 Professional Traffic Operations Engineers

11 Engineers in Training

4 Construction Observation Technicians

14 Licensed Land Surveyors

3 Surveyors in Training

27 Simultaneous Survey Crews

11 States in which TWM staff hold licenses:
Illinois | Missouri | Iowa
Indiana | Kentucky
Florida | Texas | Tennessee
Kansas | Arkansas | Oregon

Staffing & Workload

“

Our success is built upon a solid reputation for getting the job done right.
We don't compromise quality or integrity and we firmly believe that
Our Resolution of Challenges is What Sets us Apart

”

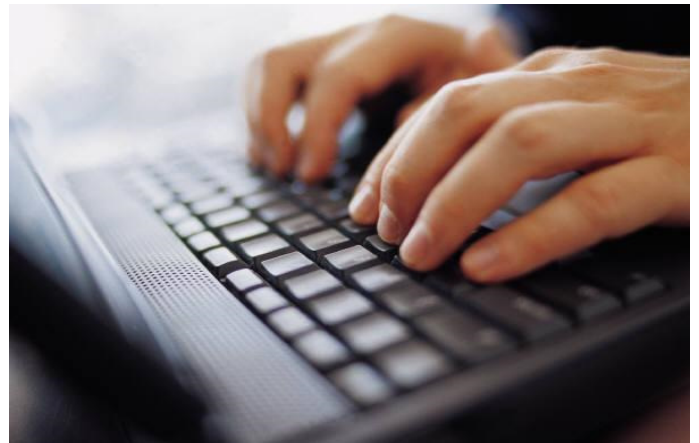

the TWM team

Perhaps as important as the qualifications of a firm as a whole are the qualifications of that firm's individual employees. Our practice is to use the collective skills of a core group of uniquely talented and qualified individuals as a team to complete all projects.

We are fully prepared to commit the team members and resources necessary to ensure your project is successfully completed within the given timeframe. The staff members for these qualifications were chosen specifically for their prior experience, familiarity, and knowledge with water infrastructure, and their ability to make your project a priority. They are experts in their respective specialized services and excited to tackle the challenges of your project. Moreover, TWM as a company possesses a strong track record of meeting, and in some cases exceeding, the proposed schedule of our clients.

Chris Bergmann will serve as **Project Manager**. He will be your primary point of contact and responsible for coordinating and directing the design and all other efforts of the project team, so that it's delivered within budget and schedule requirements. In addition to our proposed key personnel, Chris will be supported by a full team of TWM engineers, surveyors, and technical staff. Key members of the Project Team are indicated below including their role and responsibility. Complete résumés detailing each individual's background, qualifications, certifications, and experience are included in the following pages.



Chris Bergmann, PE, LEED AP BD+C | Project Manager

Years of Experience | 15

As the Director of Water Infrastructure Services at TWM, Chris is responsible for ensuring a consistent product line across all TWM offices for projects involving water infrastructure, stormwater, wastewater, or drinking water design.



Chad Ross, PE, CPESC | Sewer Alignment Review

Years of Experience | 20

Chad has extensive experience in watermain, stormwater, and sanitary sewer design and is familiar with the technical requirements and the costs that are related to construction.



Scott Simmons, PE | Cost Estimating

Years of Experience | 16

Scott has extensive experience in sewer and water main design through all phases of planning, design, and construction.



Vicki Wade, PE | QA/QC

Years of Experience | 30

Vicki designs wastewater treatment facilities, sanitary sewer collection systems, and lift/pump stations. She has also served as a Village municipal engineer, which has given her unique insights into resolving a myriad of daily challenges.





about chris

As the Director for the Water Infrastructure Services Department, Chris is responsible for oversight and design of lift stations/pump stations, wastewater treatment facilities, sanitary sewer collection systems, and water distribution systems. He is responsible for all phases of these projects, including design, permitting, and construction management. His prior experience at the Illinois EPA provided him with insight into the regulatory environment and in expediting the permitting process.

education & credentials

Master of Business Administration | University of Illinois | Springfield, IL | 2004
Bachelor of Science | Materials Science & Engineering | 2001
University of Illinois | Urbana-Champaign, IL

Professional Engineer: TN 2019 | MO 2011 | IL 2008

Leadership in Energy and Environmental Design | Accredited Professional | 2008

project experience

Terminal Lift Station & Interceptor Sewers | Shiloh, IL

Project Manager—Design of lift station and interceptor sewers; Permitting of roadway crossings with IDOT and St. Clair County; IEPA permitting; Preparation of bidding documents; Answering contractor inquiries during bidding process; Preparation of IEPA loan application.

CSO Long-Term Control Plan—Phase 2 Design | Belleville, IL

Project Manager—Design of sewers; Coordination/permitting with IDOT; Coordination/permitting with railroad; Preparation of specifications and bidding documents; Utility coordination; Answering contractor inquiries during bidding process; IEPA permitting; Preparing IEPA loan application.

North Highway Shed Sewer Design | Jefferson County, MO

Project Manager—Oversaw analysis and report of various options to handle wastewater from highway shed. Oversaw design of subsequent option selected, an updated septic system.

Lee Avenue Storm Sewer Improvements | Kirkwood, MO (MSD)

Project Manager—Oversaw design of storm sewer; Utility coordination; Communication with City of Kirkwood; Primary contact with MSD; Coordination with three sub-consultants serving various roles.

Edgemont Booster Pump Station | East St. Louis, IL (ILAWC)

Project Manager—Assumed role of project manager to finalize plans regarding new pump station and upgrading of on site piping. Coordination with ILAWC during review and with contractor throughout the construction process.

Caulks Creek Pump Station Upgrades | St. Louis, MO (MSD)

Project Manager—Preparation of design memorandum to compare various options for pump station upgrades; Oversight of initial design of improvements to existing pump station; Correspondence and coordination with MSD, utilities, and sub-consultants.

Park Street Sanitary Pump Station & Force Main Replacement | St. Peters, MO

Project Manager—Preparation of design study to evaluate pump station locations and force main routes; Oversight of initial design of new pump station and force main; Correspondence and coordination with City, utilities, railroad, and sub-consultants.

Hospital Loop Water Main Replacement | Scott Air Force Base, IL

Project Manager—Coordination of design and survey of 4,000 LF water main replacement; Coordination with Air Force Base personnel to avoid impacts to critical operations.

affiliations

- The Engineers' Club of St. Louis
- U.S. Green Building Council—St. Louis Chapter
- Society of American Military Engineers
- Water Environment Federation

talking TWM

"Having clean water is essential for a thriving society. Ensuring that our communities have access to clean water and providing them with cutting edge solutions is incredibly rewarding."

—Chris Bergmann



about chad

As a lead project engineer and project manager, Chad is responsible for the design of wastewater treatment facilities, lift stations/pump stations, sanitary sewer collection systems and water distribution systems. He is involved in all phases of projects including design, permitting and construction management. Chad has also been involved in using the latest computer software to model water systems, sanitary sewer systems and storm water systems. This has allowed TWM to develop improvement plans and master planning for future expansion for TWM's clients.

education & credentials

Master of Science | Environmental Engineering | 2001
Bachelor of Science | Civil Engineering | 1998
Missouri University of Science and Technology | Rolla, MO
Professional Engineer: IL 2004 | MO 2011
Certified Professional in Erosion and Sediment Control, Cert. No. 7566

project experience

North Oak Street Inflow & Infiltration Study | O'Fallon, IL

Lead Engineer—Responsible for developing a hydraulic computer model for the system to determine I/I flow for various rainfall occurrences in the sewer system. Modeled improvements to system improvements for I/I reduction, prepared a engineering report, and opinion of costs for various improvements.

Weinel Hills Sanitary Sewer System | Fairview Heights, IL

Project Manager—Design of sewer system: combination of gravity sewers, low pressure sewers, grinder pumps, and seven lift stations; Facility Plan Update Report to IEPA, IEPA loan application/administration, bidding administration, and construction phase engineering.

Sanitary Sewer Master Plan & Study | Mascoutah, IL

Project Manager—Developed hydraulic model from mapping; Developed various scenarios for system improvements; Developed flow projections from planning and zoning maps; Modeled improvements to system for projected growth; Prepared opinion of costs for various improvements.

Collinsville Road Sewer Crossing | Fairmont City, IL

Project Manager—Design of sewer system; Preparing specifications, bidding documents, IEPA permit application for construction; Obtained IDOT utility permit; Bidding administration; Review of pay requests and change orders.

Combined Sewer Overflow (CSO) Sewer Study | Belleville, IL

Project Engineer—Prepared CSO Long-Term Control Plan. Performed collection system modeling in SewerCAD™, determined CSO overflow rates, determined improvements, prepared IEPA report. Determined collection system capacity was greatly limited by pump station capacity at WWTP.

37th, Maple, & 42nd Storm Sewer Improvements | Fairmont City, IL

Project Manager—Design of 1266' of storm sewers and 24 inlets within flat or low-lying areas affected by standing water; CDBG application; Preparation of HUD Environmental Assessment; Preparation of plans and specifications; Bidding administration; Review of pay requests; Grant administration; Review of change orders.

Stormwater Master Plan & Study | Mascoutah, IL

Project Manager—Performed hydraulic / hydrologic calculations; Designed proposed infrastructure; Created master planning map.

Gravois Creek OMCI Stormwater Design | St. Louis MSD

Lead Design Engineer—Design of storm sewers for four locations. Completed hydraulic analysis for use in design. Prepared a StormCAD model of existing system, modeled proposed improvements to address localized flooding. Preparation of plans and specifications to meet MSD requirements.

certifications

Certified Professional in
Erosion and Sediment Control,
Cert. No. 7566

affiliations

- Water Environment Federation
- The Engineers Club of St. Louis

talking TWM

"I'm proud to be part of the TWM team. I enjoy the challenge of serving our clients' needs with simple solutions that meet the project goal and budget. We strive to put forth the best design for what's needed."

—Chad Ross



about scott

Scott has performed water / wastewater engineering through all phases of planning, design, and construction. His technical experience covers a wide range of projects including sanitary sewers, storm sewers, water distribution, hydraulic modeling, drainage, erosion control, pump station design, elevated storage design, and construction drawing and specification preparation. He is skilled in various software applications including AutoCAD, MicroStation, ArcGIS, Bentley WaterGEMS, KYPipe, and XPSWMM.

education & credentials

Bachelor of Science | 2003 | Civil Engineering
Southern Illinois University | Carbondale, IL
Professional Engineer: IL 2009

project experience

NE Corner of Frank Scott Parkway & Hartman Lane Sewer | O'Fallon, IL

Project Engineer/Manager—Design of sanitary sewers; Preparations of drawings and specifications; IEPA construction permitting; Bid phase assistance; Shop drawing review; Construction phase assistance.

11th Street Interceptor Sewer | Belleville, IL

Project Engineer/Manager—Design of sewer system improvements; Preparation of plans and specifications; IEPA permitting.

Sewer Improvements | Caseyville Township & O'Fallon, IL

Project Engineer—Preparation of drawings and specifications; Bid phase assistance; Shop drawing review; Construction phase assistance.

Crossroad Terrace Sanitary Sewer Replacement | Caseyville Township, IL

Project Manager—Preparation of St. Clair County IGD grant application; Design of replacement sanitary sewers; Preparation of plans and specifications; Construction phase assistance.

Water Study & IEPA Project Plan | Freeburg, IL

Project Manager—Preparation of WaterCAD hydraulic model to analyze the Village's water system. The model was then used to identify and prioritize improvements to the system and create an IEPA project plan for the Village.

Edgemont Booster Pump Station Improvements | IAWC, East St. Louis, IL

Project Engineer—Design of new booster pump station and site piping. Preparation of construction plans; Assisted owner during construction with review of shop drawings.

Elevated Storage Tank Rehabilitation | Fayetteville, IL

Project Manager—Coordination and design of interior and exterior coating system and various structural repairs to existing elevated storage tank; USDA Rural Development grant assistance; Construction observation.

Highway Z Water Main Upgrade | St. Charles County, MO (PWSD #2)

Project Engineer—Design of 8,100 LF water main upgrade; Preparation of plans and specifications; Permitting through DNR, MODOT, and USACE.

Waterford Crossing Water Main Relocation | St. Charles County, MO (PWSD#2)

Project Engineer/Manager—Design of water main improvements; Preparation of plans and specifications.

Gravois Creek OMCI Stormwater Design | St. Louis MSD

Project Engineer—Preparation of plans and specifications to meet MSD requirements.

special training

OSHA 10-Hour Safety
Certification

affiliations

Water Environment Federation

talking TWM

"I'm honored to be a part of TWM because we are truly a family. We work together to support our clients, we pick each other up when we fall, and we push each other to get better every day."

—Scott Simmons



about vicki

A member of TWM's Water/Wastewater group, Vicki has been responsible for the design of wastewater treatment facilities, sanitary sewer collection systems, and lift/pump stations. Vicki has served as municipal engineer for the Village of Swansea for many years. She regularly attends Village meetings and has worked hand-in-hand with the Village officials and staff to address engineering needs. This role has given her unique insights into the challenges municipalities face on a day-to-day basis.

education & credentials

Master of Science | 1992 | Environmental Engineering
Southern Illinois University | Edwardsville, IL

Bachelor of Science | 1990 | Civil Engineering
Southern Illinois University | Edwardsville, IL

Professional Engineer: MO 2006 | IL 1997

project experience

City of Belleville Long Term Control Plan—Phase 3 | Belleville, IL

Project Engineer—Phase 3 of the Long Term Control Plan for the City of Belleville required construction of a 96 MGD lift station (South Side Park CSO Pumping Station). Flows are pumped to the 'low-end' Stormwater Management Basins through either one or both of the proposed 48-inch force mains, depending on the magnitude of excess wet weather flow. The project also included installation of approximately 1,425 linear feet of 24" – 48" storm sewer. This project eliminated 4 CSO overflow points. Funded with IEPA loan money.

City of Belleville Long Term Control Plan—Phase 4 | Belleville, IL

Project Engineer—Designed Phase 4 CSO lift station to remove Combine Sewer Overflows within city limits in compliance with mandated IEPA timeline. Project consisted of construction of 25 MGD lift station, sewer line and force main connecting to Phase 3 project. The profile of the forcemain is such that there are many "high points", requiring the need for the lift station. As such, one aspect that required more attention to detail is that the lift station "pumps downhill". This project eliminated 2 combined sewer overflows. Completion of this project has reduced the Combined Sewer Overflows from 15 overflows to only 2. Funded with IEPA loan money.

Watkins Creek Pump Station Replacement | St. Louis, MO

QA/QC—Reviewed preliminary engineering report, 30%, 60%, and 95% plans.

Caulks Creek Pump Station A Improvements | St. Louis, MO

QA/QC—Provided review of preliminary engineering report, 30% plans.

Wastewater Treatment Facility I/I Study | Troy, IL

Project Manager—Worked with City personnel on a flow study in compliance with an IEPA Commitment Agreement. The flow study consisted of a compilation of data gathered from flow monitoring and plant data. This data was used to proposed improvements and rehabilitation to the existing sewer system.

Grant & Permit Applications

Vicki is especially skilled and knowledgeable in the research, preparation, and submittal of various types of grants and permit applications including MS4, CDBG, IGD, NPDES, CDAP, and Missouri DNR. Her grant and permit work has been instrumental in the successful completion of a wide spectrum of projects for TWM clients, including the municipalities of Swansea, Mascoutah, Fairmont City, Millstadt, St. Libory, Caseyville Township, and Fayetteville.

talking TWM

"My personal and professional mantra is ... keep going, keep growing."

—Vicki Wade



personnel planning

The City of Washington is obviously interested in whether TWM has the capacity to take on an additional project and complete that new project on time. In consideration of our current projects, none would prevent us from working with the City of Washington upon Notice to Proceed. Our current workload allows for TWM to commit 50% availability or higher in 2021 and 2022 if needed.

For your project, all work will be completed with TWM staff from our St. Louis, Peoria, and Swansea offices. Our staff possess the specialized work experience and technical competence required to successfully provide engineering services to the City of Washington.

We currently have ample capacity to dedicate the resources necessary for timely completion of the project. The chart below indicates each team member's percentage of availability that's needed for this project, their overall availability, and obligated time on other projects. We also have the flexibility to work in person as well as in a virtual environment.

TEAM AVAILABILITY

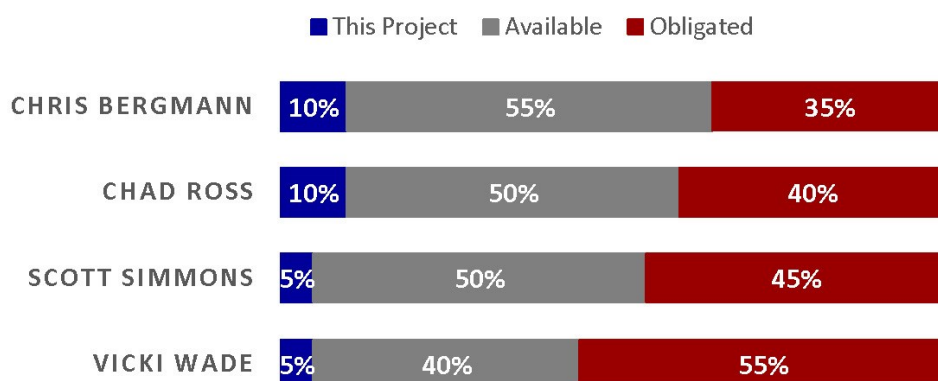

Why Choose TWM?

As a full-service firm with a highly skilled team of professionals, we can solve nearly any problem or challenge your project may face. TWM provides a comprehensive approach, a smooth workflow, and the right solution to meet challenges every step of the way. With TWM:

- Your project needs are understood
- You can expect us to take an innovative look
- Your timeline is respected and will be completed on schedule
- Your project and scope of work will be developed with realistic estimates and budget in mind
- Your project will be done with confidence

Choosing a firm with the knowledge, skill, and experience to complete your project correctly is so important. **We proudly retain approximately 95% of our clients.** We attribute much of our success to a commitment for collaborative communication with clients and outside entities. We meet with our clients regularly, calling at least monthly to check in with them. Our clients also have the comfort of knowing that we prioritize availability of our staff.

five core values define our work

QUALITY

We strive for QUALITY in every aspect of our work, so that we will never be afraid to put our seal on a design and stand behind that work.

RELATIONSHIPS

We have built our business on the foundation of RELATIONSHIPS. Our clients trust us. Many would do business with us on a handshake.

STABILITY

TWM is conservative in its fiscal and operational approach to business. We have been in business for 70+ years, and our employees and clients do not have to worry about our STABILITY or whether we are going to be in business next week or next year.

AMBITION

We value and therefore hire employees who are determined and persevere, who have AMBITION and a can-do attitude and who do not give up.

LOYALTY

We also value employees who exhibit LOYALTY and true teamwork and are in the game 100%—head, hands, and heart—working together with eyes on the goal and putting forth whatever effort it takes to achieve that goal.



Consultant's Disclosure Statement RETURN WITH STATEMENT OF INTEREST

PTB #: City of Washington

Consultant Name Thouvenot, wade & Moerchen, Inc.	
Legal Address 4940 Old Collinsville Rd.	
City, State, Zip Swansea, IL 62226	
Telephone Number 618-624-4488	Email Address RDeConcini@twm-inc.com

The telephone number and email address supplied above must be a contact readily available if the Illinois Department of Transportation (IDOT) has questions.

The disclosures hereinafter made by the firm are each a material representation of fact upon which reliance is placed should IDOT enter into the contract with the firm. The firm further certifies that the Department has received the disclosure forms for each Statement of Interest.

Section 50-35 of the Illinois Procurement Code provides that all offers of more than \$50,000 and all subconsultant agreements with an annual value of more than \$50,000 shall be accompanied by disclosure of the financial interests of the firm. This disclosed information for the successful firm will be maintained and subject to release by request pursuant to the Freedom of Information Act, filed with the Procurement Policy Board, and shall be incorporated as a material term of the contract. Furthermore, pursuant to Section 5-5, the Procurement Policy Board may review a proposal, bid, or contract and issue a recommendation to void a contract or reject a proposal or bid based on any violation of the Procurement Code or the existence of a conflict of interest as provided in subsections (b) and (d) of Section 50-35.

Prime Consultant's Responsibility

The IDOT Chief Procurement Officer (CPO) may void the offer or contract if it is later determined that the prime or subconsultant rendered a false or erroneous disclosure. A prime consultant or subconsultant may be suspended or debarred for violations of the Procurement Code. If a false certification is made by the subconsultant, then the prime consultant's submitted offer and the executed contract may not be declared void, unless the prime consultant refuses to terminate the subconsultant upon the State's request after a finding that the subconsultant's certification was false.

Instructions

The following packet includes three sections that must be completed and returned with the Statement of Interest, or the firm may be considered nonresponsive and the Statement of Interest will not be accepted:

1. Qualifying Questions for Form A,
2. Form A: Financial Information & Potential Conflicts of Interest Disclosure, and
3. Form B: Other Contracts & Procurement-Related Information Disclosure.

Form A and Form B must be signed and dated by a person that is authorized to execute contracts for your organization. Photocopied or stamped signatures are not acceptable. The person signing can be, but does not have to be, the person for which the form is being completed. The firm is responsible for the accuracy of any information provided.

Checking the NOT APPLICABLE STATEMENT on Form A does not allow the firm to ignore Form B. Form B must be completed, checked, and dated.

Form A: Financial Information & Potential Conflicts of Interest Disclosure

Form A pertains to the individuals meeting the ownership or distributive share requirements as stated below.

The financial interests to be disclosed shall include:

- Any ownership or distributive income share that is in excess of 5% or an amount greater than 60% of the annual salary of the Governor, of the offering entity or its parent entity, whichever is less, **the current annual salary of the Governor is \$177,412.00.**
- If the firm is a publicly traded entity subject to Federal 10K reporting, in which case it may submit its 10K disclosure in place of the prescribed disclosure.
- If a firm is a privately held entity that is exempt from Federal 10K reporting, but has more than 100 shareholders, it may submit the information that Federal 10K companies are required to report and list the names of any person or entity holding any ownership share that is in excess of 5%.
 - *If this is true for your firm, check "Other" box on Form A and designate the firm is a 10K and supply the 10K documents as additional attachments within the disclosure.*
- The names, addresses, and dollar or proportionate share of ownership of each person making the disclosure, their instrument of ownership or beneficial relationship, and notice of any potential conflict of interest resulting from the current ownership or beneficial interest of each person making the disclosure having any of the relationships identified in Section 50-35 and on the disclosure form.

A button is supplied on Form A called "Add another Form A", which once clicked will copy Form A. Click the button as many times as you need to identify individuals who meet the above criteria.

Form B: Other Contracts & Procurement-Related Information Disclosure

The firm shall identify, by checking "Yes" or "No" on Form B any other current or pending contracts, proposals, leases, or other ongoing procurement relationships the offering entity has with IDOT and any other unit of state government and shall clearly identify the unit and the contract, proposal, lease, or other relationships.

If "Yes" is checked, the firm must identify each such relationship by listing the State of Illinois agency name and other descriptive information such as project number, title, contract, etc.

If "No" is checked, the firm only needs to check the box, sign and date at the bottom of Form B.

Qualifying Questions for Form A

The following six questions must be answered in order to determine how Form A is to be completed. Answer all six questions before going on to Form A.

Ownership Certification

The following clarifies the ownership structure of your firm for IDOT's review.

	Yes	No
1. Is your firm a Subsidiary and owned by a Parent entity(ies)?	<input type="checkbox"/>	<input checked="" type="checkbox"/>
If your answer is "Yes", please disclose the Parent entity(ies) on Form A.		
2. Will the individuals that will be submitted on Form A equal 100% ownership?	<input checked="" type="checkbox"/>	<input type="checkbox"/>
If your answer is "No", please answer the following question.		
a) Does any of the remaining ownership held by individuals receiving or holding less than 5% of the offering entity's or parent entity's total distributive income, or less than 60% of the annual salary of the Governor?	<input type="checkbox"/>	<input type="checkbox"/>

Identifying Financial Information & Potential Conflicts of Interest

	Yes	No
3. Does anyone in your organization have a direct or beneficial ownership share of greater than 5% of the offering entity or parent entity?	<input checked="" type="checkbox"/>	<input type="checkbox"/>
4. Does anyone in your organization have a direct or beneficial ownership share of less than 5%, but which has a value greater than 60% of the annual salary of the Governor?	<input checked="" type="checkbox"/>	<input type="checkbox"/>
5. Does anyone in your organization receive more than 60% of the annual salary of the Governor of the offering entity's or parent entity's distributive income? (Note: Distributive income is, for these purposes, any type of distribution of profits. An annual salary is not distributive income.)	<input checked="" type="checkbox"/>	<input type="checkbox"/>
6. Does anyone in your organization receive greater than 5% of the offering entity's or parent entity's total distributive income, but which is less than 60% of the annual salary of the Governor?	<input checked="" type="checkbox"/>	<input type="checkbox"/>

If the answer to questions 3 – 6 are "Yes", the completion of Form A is required, and the APPLICABLE STATEMENT must be signed and dated.

If the answer to questions 3 - 6 are "No", then the NOT APPLICABLE STATEMENT of Form A must be signed and dated.



Form A: Financial Information & Potential Conflicts of Interest Disclosure

Disclosure of the information contained in this form is required by Section 50-35 of the Illinois Procurement Code (30 ILCS 500). Firms desiring to enter into a contract with the State of Illinois must disclose the financial information and potential conflict of interest information as specified in this Disclosure Form.

Disclosure of Financial Information

The individual named below has an interest in the FIRM (or its Parent) in terms of ownership or distributive income share that is in excess of 5%, or an interest which has a value of more than 60% of the annual salary of the Governor.

FOR INDIVIDUAL

Name: Thouvenot, Wade & Moerchen, Inc., Employee Stock Ownership Plan (ESOP)
Address: 4940 Old Collinsville Rd.
Swansea, IL 62226

- ☐ Stock with % or \$ value of ownership/distributable income share: _____
☒ Employee Stock Ownership Plan (ESOP)
☐ Other (explain): _____

Disclosure of Potential Conflicts of Interest

Firm must check "Yes" or "No" to indicate which, if any, of the following potential conflict of interest relationships apply. If the answer to any question is "Yes", please describe and attach additional pages if needed.

- | | Yes | No |
|--|--------------------------|-------------------------------------|
| 1. State employment , currently or in the previous three years, including contractual employment of services? | <input type="checkbox"/> | <input checked="" type="checkbox"/> |

If your answer is "Yes", please answer each of the following questions.

- | | | |
|--|--------------------------|--------------------------|
| a) Are you currently an officer or employee of either the Capital Development Board or the Illinois State Toll Highway Authority? | <input type="checkbox"/> | <input type="checkbox"/> |
| b) Are you currently appointed to or employed by any agency of the State of Illinois? If you are currently appointed to or employed by any agency of the State of Illinois, and your annual salary exceeds 60% of the annual salary of the Governor, provide the name of the state agency for which you are employed and your annual salary: | <input type="checkbox"/> | <input type="checkbox"/> |
| <hr/> | | |
| c) If you are currently appointed to or employed by any agency of the State of Illinois, and your annual salary exceeds 60% of the annual salary of the Governor, are you entitled to receive (i) more than 7 1/2% of the total distributable income of your firm, partnership, association or corporation, or (ii) an amount in excess of the salary of the Governor? | <input type="checkbox"/> | <input type="checkbox"/> |
| d) If you are currently appointed to or employed by any agency of the State of Illinois, and your annual salary exceeds 60% of the annual salary of the Governor, are you and your spouse or minor children entitled to receive (i) more than 15% in the aggregate of the total distributable income of your firm, partnership, association or corporation, or (ii) an amount in excess of two times the salary of the Governor? | <input type="checkbox"/> | <input type="checkbox"/> |



	Yes	No
2. State employment of spouse, father, mother, son, or daughter, including contractual employment services in the previous two years?	<input type="checkbox"/>	<input checked="" type="checkbox"/>
If your answer is yes, please answer each of the following questions.		
a) Is your spouse or any minor children currently an officer or employee of the Capital Development Board or the Illinois State Toll Highway Authority?	<input type="checkbox"/>	<input type="checkbox"/>
b) Is your spouse or any minor children currently appointed to or employed by any agency of the State of Illinois? If your spouse or minor children is/are currently appointed to or employed by any agency of the State of Illinois, and his/her annual salary exceeds 60% of the annual salary of the Governor, provide the name of your spouse and/or minor children, the name of the state agency for which he/she is employed and his/her annual salary.	<input type="checkbox"/>	<input type="checkbox"/>
c) If your spouse or any minor children is/are currently appointed to or employed by any agency of the State of Illinois, and his/her annual salary exceeds 60% of the annual salary of the Governor, are you entitled to receive (i) more than 7 1/2% of the total distributable income of your firm, partnership, association or corporation, or (ii) an amount in excess of 100% of the annual salary of the Governor?	<input type="checkbox"/>	<input type="checkbox"/>
d) If your spouse or any minor children are currently appointed to or employed by any agency of the State of Illinois, and his/her annual salary exceeds 60% of the annual salary of the Governor, are you and your spouse or minor children entitled to receive (i) more than 15% in the aggregate of the total distributable income of your firm, partnership, association or corporation, or (ii) an amount in excess of two times the salary of the Governor?	<input type="checkbox"/>	<input type="checkbox"/>
3. Elective status: the holding of elective office of the State of Illinois, the government of the United States, any unit of local government authorized by the Constitution of the State of Illinois or the statutes of the State of Illinois currently or in the previous three years?	<input type="checkbox"/>	<input checked="" type="checkbox"/>
4. Relationship to anyone holding elective office currently or in the previous two years: spouse, father, mother, son or daughter?	<input type="checkbox"/>	<input checked="" type="checkbox"/>
5. Appointive office: the holding of any appointive government office of the State of Illinois, the United States of America, or any unit of local government authorized by the Constitution of the State of Illinois or the statutes of the State of Illinois, which office entitles the holder to compensation in excess of the expenses incurred in the discharge of that office currently or in the previous three years?	<input type="checkbox"/>	<input checked="" type="checkbox"/>
6. Relationship to anyone holding appointive office currently or in the previous two years: spouse, father, mother, son or daughter?	<input type="checkbox"/>	<input checked="" type="checkbox"/>
7. Employment, currently or in the previous three years, as or by any registered lobbyist of the state government?	<input type="checkbox"/>	<input checked="" type="checkbox"/>
8. Relationship to anyone who is or was a registered lobbyist in the previous two years: spouse, father, mother, son, or daughter?	<input type="checkbox"/>	<input checked="" type="checkbox"/>
9. Compensated employment, currently or in the previous three years, by any registered election or re-election committee registered with the Secretary of State or any county clerk of the State of Illinois, or any political action committee registered with either the Secretary of State or the Federal Board of Elections?	<input type="checkbox"/>	<input checked="" type="checkbox"/>



10. Relationship to anyone; spouse, father, mother, son, or daughter; who was a compensated employee in the last two years by any registered election or re-election committee registered with the Secretary of State or any county clerk of the State of Illinois, or any political action committee registered with either the Secretary of State or the Federal Board of Elections? Yes ☐ No ☒

11. **Communication Disclosure.** Disclose the name and address of each lobbyist and other agent of the firm or offeror who is not identified in Form A, who has communicated, is communicating, or may communicate, with any state officer or employee concerning the statement of interest, bid or offer. This disclosure is a continuing obligation and must be promptly supplemented for accuracy throughout the process and throughout the term of the contract. If yes, supply name and address of person(s) below: Yes ☒ No ☐

TWM currently retains Chris Stone through CapStone and Jim Reimer, Jr. through Governmental Consulting Solutions as consultants in the matters of legislative proceedings, various State Agency policy and procedure, to facilitate meetings with public officials as may be needed to clarify our understanding of applicable policy and procedure, all to ensure that we stay apprised of current policy, procedure and related matters as well as any potential changes that may affect our operations as they pertain to such.

Governmental Consulting Solutions, Inc. is located at 420 Capitol Ave, Suite 1, Springfield, IL 62704. CapStone is located at 524 S. 2nd Street, Springfield, Illinois 62701.

12. **Suspension or Debarment Disclosure.** For each of the persons identified under Form A, disclose whether any of the following has occurred within the previous 10 years: suspension or debarment from contracting with any governmental entity; professional licensure discipline; bankruptcies; adverse civil judgments and administrative findings; and criminal felony convictions. This disclosure is a continuing obligation and must be promptly supplemented for accuracy throughout the procurement process and term of the contract, if the bid or offer is successful. If yes, supply information below: Yes ☐ No ☒

Name of person(s): _____

Nature and date of disclosure: _____

If the answers to questions 3 – 6 are "Yes" under "Qualifying Questions for Form A", check the box, sign and date below under "Not Applicable Statement":

Applicable Statement

This Disclosure Form A is submitted on behalf of the INDIVIDUAL named on previous page. Under penalty of perjury, I certify the contents of this disclosure to be true and accurate to the best of my knowledge.

Completed by: ☒

Signature of Individual or Authorized Officer

9/7/21

Date

If the answers to questions 3 - 6 are all "No", under "Qualifying Questions for Form A", check the box, sign and date below under "Not Applicable Statement":

Not Applicable Statement

Under penalty of perjury, I have determined that no individuals associated with this organization meet the criteria that would require the completion of this Form A.

This Disclosure Form A is submitted on behalf of the FIRM listed on the first page.



Completed by: ☐

Signature of Individual or Authorized Officer

Date

The firm has a continuing obligation to supplement these disclosures under Sec. 50-35 of the Procurement Code.

Form B: Other Contracts & Procurement-Related Information Disclosure

Disclosure of the information contained in this form is required by Section 50-35 of the Illinois Procurement Code (30 ILCS 500). This information shall become part of the publicly available contract file. This Form B must be completed for Statements of Interest in excess of \$50,000, and for all open-ended contracts. This Form B must also be completed for subconsultant agreements with an annual value of more than \$50,000 from subconsultants identified in Section 20-120 in the Illinois Procurement Code and for all open-ended subconsultant agreements.

Disclosure of Other Contracts and Procurement-Related Information

Answer the following question.

Yes

No

1. Does the firm have any pending contracts (including leases), statements of interest, bids, proposals, or other ongoing procurement relationship with IDOT or any other State of Illinois agency?

☒

☐

If your answer is "No", the firm only needs to complete the signature box on the bottom of this page.

If your answer is "Yes", identify each such relationship by showing the agency name, PTB/PSB if applicable, Project name and the role of your firm as either a Prime or Sub (attach additional pages as necessary).

AGENCY	PTB/PSB	PROJECT NAME	ROLE (PRIME/ SUB FIRM)
Please see attachment.			

Add A Row

This Disclosure Form B is submitted on behalf of the INDIVIDUAL named on previous pages. Under penalty of perjury, I certify the contents of this disclosure to be true and accurate to the best of my knowledge.

Completed by: ☒

Signature of Individual or Authorized Representative

9/7/21

Date

Contracts/Pending Contracts, Bids and Proposals

If you selected Option 1, 2, 3, 4, or 6 in Step 1, do you have any contracts, pending contracts, bids, proposals, or other ongoing procurement relationships with units of State of Illinois government? ☒ Yes
☐ No.

If "Yes", please specify below. Attach an additional page in the same format as provided below, if desired.

Agency	PTB/PSB	Project Name	Role (Prime/Sub Firm)
Illinois Department of Transportation	PTB 169-036	Job #P-98-071-13; Various, Various for District 8	Prime (15% required DBE)
Illinois Department of Transportation	PTB 180-013	Job #C-94-052-16; Various, Various for District 4 Local Roads	Prime (25% required DBE)
Illinois Department of Transportation	PTB 183-015	Job # P-98-040-16; Various, Various for District 8	Prime (20% required DBE)
Illinois Department of Transportation	PTB 184-029	Job #D-98-085-17; Various Utility Coordination for District 8.	Sub to Thompson Civil
Illinois Department of Transportation	PTB 188-023	Job # P-95-013-98 – Tilton over FAI-74; Tilton, IL District 5	Prime (19% required DBE)
Illinois Department of Transportation	PTB 189-023	Job # P-95-025-18; Various, Various for District 5	Sub to Civil Design, Inc. (CDI)
Illinois Department of Transportation	PTB 190-035	Job #D-99-067-18; Various, Various for District 9	Sub to Oates & Associates
Illinois Department of Transportation	PTB 192-012	Job #D-94-014-19; Various, Various for District 4	Prime (21% required DBE)
Southern Illinois University, Carbondale, IL	No. 8122 – QBS No. 36	SIUE on-call – PO #118898	Prime
Illinois Department of Transportation	PTB 194-046	Job #D-96-016-20; Various, Various for District 6	Prime (21% required DBE)
Illinois Department of Transportation	PTB 185-021	Job #D-98-071-17; Various, Various for District 8	Sub to Quigg & Associates
Illinois Department of Transportation	PTB 196-053	Job #D-98-038-20; Various, Various for District 8	Sub to Engineering Design Source, Inc.
Illinois Department of Transportation	PTB 169-038	Job #D-30-004-14; State-Wide Emergency Response System	Sub to Wiss, Janney, Elster Associates, Inc.
Illinois Department of Transportation	PTB 193-025	Job #D-95-014-19; Various, Various for District 5	Sub to Prairie Engineers
Illinois Department of Transportation	PTB 197-027	Job #D-95-032-10; Phase I & II FAI-74 over Griffin & Stoney Creek for District 5	Prime (22% required DBE)
Illinois Department of Transportation	PTB 200-040	Job #P-99-006-21; Various, Various for District 9; (under negotiation)	Prime (22% required DBD)